

**vtech**<sup>®</sup>  
Baby

# Parent's Guide

## Soothing Songbirds Travel Mobile™



# INTRODUCTION

Thank you for purchasing the **Soothing Songbirds Travel Mobile™**. This mobile helps soothe your little one to sleep with spinning songbirds, lights and relaxing music. The compact mobile easily attaches to cribs, strollers and infant carriers.

Time Selector  
Switch

Volume Control  
Buttons

Light-Up  
Button

On/Off/Mobile  
Switch

Night Light  
Button

Claw  
Attachment

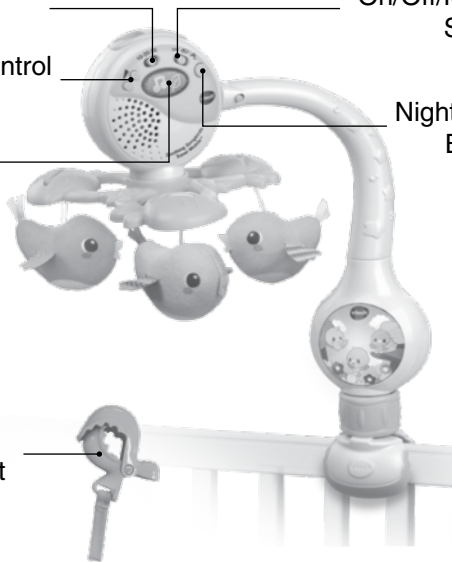

# INCLUDED IN THIS PACKAGE

- One **Soothing Songbirds Travel Mobile™** electronic module
- One mobile support post
- One mobile with three plush dangling songbirds
- One claw attachment with elastic strap with hook and loop closure
- One parent's guide

**WARNING:** All packing materials such as tape, plastic sheets, packaging locks, removable tags, cable ties and packaging screws are not part of this toy, and should be discarded for your child's safety.

**NOTE:** Please keep this parent's guide as it contains important information.

**ATTENTION :** Pour la sécurité de votre enfant, débarrassez-vous de tous les produits d'emballage tels que rubans adhésifs, feuilles de plastique, attaches, étiquettes et vis d'emballage. Ils ne font pas partie du jouet.

**NOTE :** Il est conseillé de conserver ce guide des parents car il comporte des informations importantes.

**Unlock the packaging locks:**

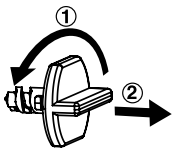

① Turn the packaging lock counterclockwise several times.

② Pull out and discard the packaging lock.

# GETTING STARTED

## BATTERY INSTALLATION

1. Make sure the unit is turned **OFF**.
2. Locate the battery cover on the back of the electronic module. Use a screwdriver to loosen the screws.
3. Install 3 new AA (AM-3/LR6) batteries following the diagram inside the battery box. (The use of new alkaline batteries is recommended for maximum performance.)
4. Replace the battery cover and tighten the screws to secure.

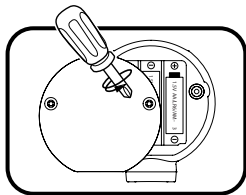

## BATTERY NOTICE

- Use new alkaline batteries for maximum performance.
- Use only batteries of the same or equivalent type as recommended.
- Do not mix different types of batteries: alkaline, standard (carbon-zinc) or rechargeable, or new and used batteries.
- Do not use damaged batteries.
- Insert batteries with the correct polarity.
- Do not short-circuit the battery terminals.
- Remove exhausted batteries from the toy.
- Remove batteries during long periods of non-use.
- Do not dispose of batteries in fire.
- Do not charge non-rechargeable batteries.
- Remove rechargeable batteries from the toy before charging (if removable).
- Rechargeable batteries are only to be charged under adult supervision.

## DEMO TAG

The demo tag should be removed automatically when the product is taken out of the packaging. If the demo tag is still in position, please remove the plastic strip from the back of the product before placing in the crib. This will activate normal play.

With the **Soothing Songbirds Travel Mobile™**, safety comes first.

- Keep the mobile out of baby's reach. To avoid injuries, please remove the mobile from crib once baby begins sitting or pushing up on all fours.
- Age range of mobile - Birth to 5 months
- The crib mobile is intended for visual stimulation and is not intended to be grasped by a child.
- For best performance, avoid attaching mobile to circular bars or other fabric-wrapped surfaces.
- Always attach all provided fasteners (strings, straps, clamps, etc.) tightly to the crib according to the instructions. Check frequently. Attach only to cribs with sturdy rails and spindles.
- Do not add additional strings or straps to attach to a crib.
- To ensure your child's safety, the product should be assembled by an adult.
- NEVER use this product in a motor vehicle. Death or serious injury can occur from hard objects in the event of a motor vehicle accident.

# ASSEMBLY INSTRUCTIONS

To ensure your child's safety, adult assembly is required. Please ensure that the crib attachment clamp is securely locked into position to avoid injury. Follow the instructions below carefully and make sure the final assembly is correct.

1. Attach the mobile to the bottom of the electronic module. You will hear the mobile click into place when inserted correctly.



2. Attach the mobile support post to cribs with rails that are between .40 inches and 1.57 inches wide. Twist the green sleeve to tighten the clamp to the crib rail. Pull slightly on the support post to make sure the clamp has been securely fastened. Please check the support post frequently to ensure it is still secure. Do not clamp mobile on a circular bar or surfaces wrapped in fabric.



3. Attach the electronic module to the support post by pressing the small green button on the support post while sliding the electronic module onto the support post. Check to make sure the electronic module is attached securely to avoid injuries.



4. To use the mobile as a travel mobile, remove the electronic module from the mobile support post by pulling gently on the mobile support post while pressing the green button on the support post.



5. Thread the elastic hook and loop closure through the slot on the top of the electronic module, securing the hook and loop fabric together.

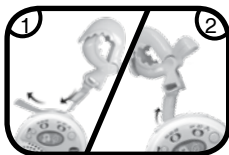

6. Use the claw attachment to attach the mobile to strollers. Always check to make sure the mobile is attached securely to avoid injuries.

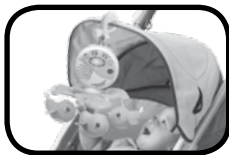

7. Use the elastic hook and loop closure to attach the mobile to infant carriers. Always check to make sure the mobile is attached securely to avoid injuries.



# PRODUCT FEATURES

## 1. On/Off/Mobile Switch

To turn the unit **ON**, slide the **On/Off/Mobile Switch** to the **Turning Mode** (🎵) or the **Stationary Mode** (🎵) position. To turn the unit **OFF**, slide the **On/Off/Mobile Switch** to the **OFF** position.



## 2. Time Selector Switch

Slide the **Time Selector Switch** to the 10, 20 or 30 minute position.



## 3. Volume Control Buttons

To adjust the volume, press the **VOLUME +** and **VOLUME -** buttons.



## 4. Night Light Button

Press the **Night Light Button** to turn the night light on or off. This feature only works when the mobile is connected to the mobile support post.



## 5. Sound Sensor

The **Soothing Songbirds Travel Mobile™** is equipped with a special sound sensor. To preserve battery life, the sound sensor will only function when the mobile is connected to the mobile support post. Once the selected time setting has ended, the unit will automatically power down. The sensor will reactivate the program when it detects your baby's cry for several seconds without interruption.



## 6. Automatic Shut Off

To preserve battery life, the **Soothing Songbirds Travel Mobile™** will automatically power down after the selected time has ended. The unit can be turned on again by pressing any button.

**Note:** If the unit repeatedly powers down while playing or the light-up button fades out, we suggest changing the batteries.

# ACTIVITIES

## 1. On/Off/Mobile Switch

Slide the **On/Off/Mobile Switch** to turn the unit on. You will hear a soothing phrase followed by relaxing music. The light-up button will fade in and out with the sound when the electronic module is removed from the mobile support post.



## 2. Light-Up Button

Press the **Light-Up Button** to change to the next song or melody. Hold down the light-up button to hear a short tune. The light-up button will fade in and out with the sound when the electronic module is removed from the mobile support post.

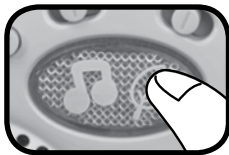

# MELODY LIST

1. A-Tisket, A-Tasket
2. All Through the Night
3. Are You Sleeping?
4. Baa Baa Black Sheep
5. Cradle Song - Mozart
6. Hot Cross Buns
7. Humpty Dumpty
8. Hush Little Baby
9. Rock-a-bye Baby
10. Jack and Jill

11. Little Bo Peep
12. Little Miss Muffet
13. London Bridge
14. Muffin Man
15. Here We Go Round the Mulberry Bush
16. Polly Put the Kettle On
17. Pussy Cat, Pussy Cat
18. Ring Around the Rosy
19. Row, Row, Row Your Boat
20. Simple Simon
21. Sing a Song of Sixpence
22. Swing Low, Sweet Chariot
23. Twinkle, Twinkle, Little Star
24. One Man Went to Mow a Meadow
25. Bicycle Built for Two
26. Cradle Song - Weber
27. Glow Worm
28. Diddle, Diddle Dumpling
29. White Coral Bells
30. Hey Diddle Diddle
31. Mary, Mary Quite Contrary
32. Aiken Drum
33. My Bonnie Lies Over the Ocean
34. To Market, To Market
35. Three Blind Mice
36. Clementine
37. Cockles & Mussels
38. Goodnight Ladies
39. Alouette
40. Beautiful Dreamer

## SONG LYRICS

### Song 1

Hush, little baby, don't say a word.  
Papa's gonna buy you a mockingbird.  
And if that mockingbird won't sing,  
Papa's gonna buy you a diamond ring.

## Song 2

Sleep, my child, and peace attend thee,  
All through the night.  
Guardian angels I will send thee,  
All through the night.

## Song 3

Ring around the rosy,  
A pocket full of posies,  
Hush-a, hush-a,  
We all fall down.

# CARE & MAINTENANCE

1. Keep the unit clean by wiping it with a slightly damp cloth.
2. Keep the unit out of direct sunlight and away from any direct heat sources.
3. Remove the batteries when the unit is not in use for an extended period of time.
4. Do not drop the unit on a hard surface and do not expose the unit to excess moisture.
5. The songbirds are hand washable. Please remove the electronic module and follow the care instructions on the label.

# TROUBLESHOOTING

If for some reason the program/activity stops working or malfunctions, please follow these steps:

1. Turn the unit **OFF**.
2. Interrupt the power supply by removing the batteries.
3. Let the unit stand for a few minutes, then replace the batteries.
4. Turn the unit back **ON**. The unit will now be ready to play again.
5. If the unit still does not work, replace with an entire set of new batteries.

If the problem persists, please call our Consumer Services Department at 1-800-521-2010 in the U.S. or 1-877-352-8697 in Canada, or by going to our website at [vtechkids.com](http://vtechkids.com) and filling out our Contact Us form located under the Customer Support link. A service representative will be happy to help you.

**IMPORTANT NOTE:**

Creating and developing **VTech**<sup>®</sup> products is accompanied by a responsibility that we at **VTech**<sup>®</sup> take very seriously. We make every effort to ensure the accuracy of the information, which forms the value of our products. However, errors sometimes can occur. It is important for you to know that we stand behind our products and encourage you to call our Consumer Services Department at 1-800-521-2010 in the U.S. or 1-877-352-8697 in Canada, or by going to our website at [vtechkids.com](http://vtechkids.com) and filling out our Contact Us form located under the Customer Support link with any problems and/or suggestions that you might have. A service representative will be happy to help you.

**Note:**

This equipment has been tested and found to comply with the limits for a Class B digital device, pursuant to Part 15 of the FCC Rules. These limits are designed to provide reasonable protection against harmful interference in a residential installation. This equipment generates, uses and can radiate radio frequency energy and, if not installed and used in accordance with the instructions, may cause harmful interference to radio communications. However, there is no guarantee that interference will not occur in a particular installation. If this equipment does cause harmful interference to radio or television reception, which can be determined by turning the equipment off and on, the user is encouraged to try to correct the interference by one or more of the following measures:

- Reorient or relocate the receiving antenna.
- Increase the separation between the equipment and receiver.
- Connect the equipment into an outlet on a circuit different from that to which the receiver is connected.
- Consult the dealer or an experienced radio/TV technician for help.

THIS DEVICE COMPLIES WITH PART 15 OF THE FCC RULES. OPERATION IS SUBJECT TO THE FOLLOWING TWO CONDITIONS: (1) THIS DEVICE MAY NOT CAUSE HARMFUL INTERFERENCE, AND (2) THIS DEVICE MUST ACCEPT ANY INTERFERENCE RECEIVED, INCLUDING INTERFERENCE THAT MAY CAUSE UNDESIRABLE OPERATION.

*CAN ICES-3 (B)/NMB-3(B)*

**Caution:** Changes or modifications not expressly approved by the party responsible for compliance could void the user's authority to operate the equipment.

#### **Supplier's Declaration of Conformity**

Trade Name:	VTech®
Model:	5131
Product name:	Soothing Songbirds Travel Mobile™
Responsible Party:	VTech Electronics North America, LLC
Address:	1156 W. Shure Drive, Suite 200, Arlington Heights, IL 60004
Website:	vtechkids.com

**Adult assembly required**  
**Ce jouet doit être assemblé**  
**par un adulte.**

**Visit our website for more  
information about our products,  
downloads, resources and more.**

***vtechkids.com***

Read our complete warranty policy online at  
*vtechkids.com/warranty*

